



# HINGECRAFT

CORPORATION

3601 LEXINGTON PARK DR, ELKHART, IN 46514  
PHONE: 574-293-6543 FAX: 574-293-3199

With over 30 years in the industry, Hingecraft has mastered the art of creating customized hinges for any and all needs for use on items as small as bird feeders, to as large as busses. The most popular materials we use are Stainless, Bright Stainless, & Plain Steel, Aluminum, Pre-Painted Aluminum, Cold Roll, HRPO, as well as Brass & Nickle Plated Steel.



# HINGECRAFT

CORPORATION  
3601 LEXINGTON PARK DR. ELKHART, IN 46514



## Hinge Samples

The following pictures depict several of the hinges we are currently making, as well as older hinges no longer in production. This is to show some of the different hinge styles we are capable of producing here at Hingecraft. We work with your diagrams to produce a hinge that is to your exact specifications. Please contact us to see how we can help you create the perfect hinge.

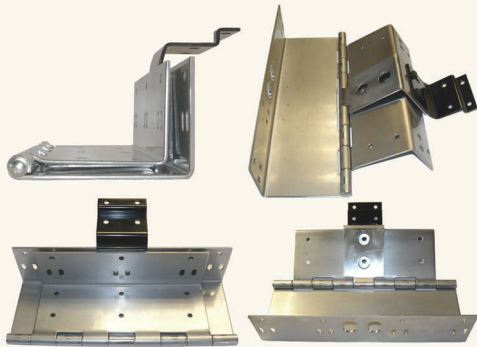
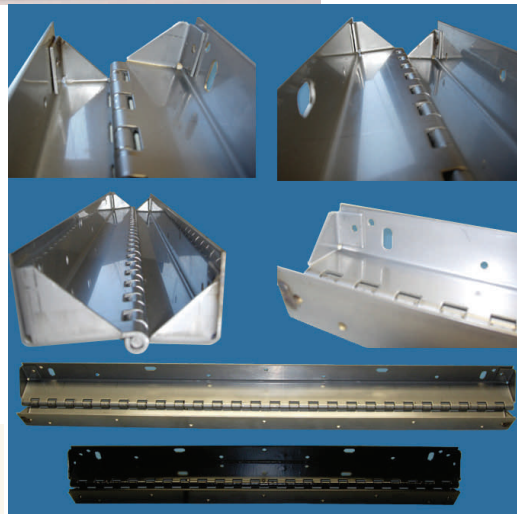
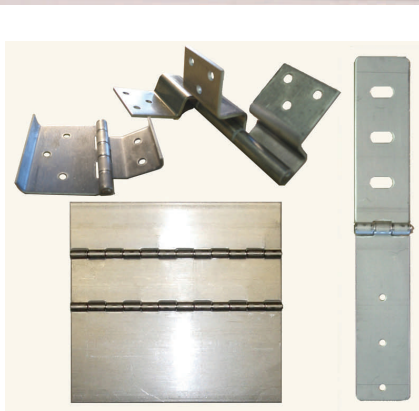
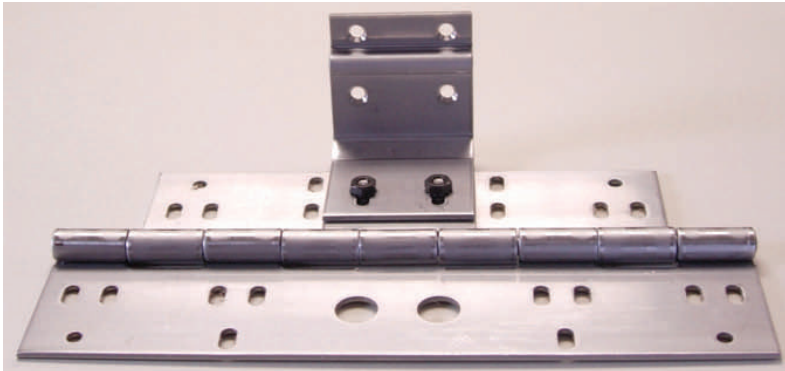



# HINGECRAFT

CORPORATION  
3601 LEXINGTON PARK DR. ELKHART, IN 46514



## Special Piercing & Swaging Hinges

### PLAIN OR STANDARD ASSEMBLY

This is a surface-type hinge. The leaves lie flat in the same plane when in the open position. Unless otherwise indicated, this type of hinge will be furnished

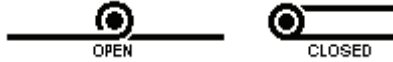

### SWAGING

The forming of one or both leaves toward or beyond the center of the pin, swaging slightly increases leaf width.



### BOTH LEAVES HALF-SWAGED

Both leaves are swaged approximately one-half the pin diameter with a minimum clearance between leaves when parallel.



### ONE LEAF HALF-SWAGED

One leaf swaged one half the pin diameter.



### ONE LEAF FULL-SWAGED

One leaf swaged equal to the pin diameter and both leaves parallel when in a closed



### REVERSE SWAGED

One leaf swaged to simulate reverse assembly. Leaves will not close to a parallel posi-



### OFFSET

Forming one or both leaves away from the center of the pin. Offsetting slightly decreases leaf width.





# HINGECRAFT

CORPORATION  
3601 LEXINGTON PARK DR. ELKHART, IN 46514



## Piercing Terminology

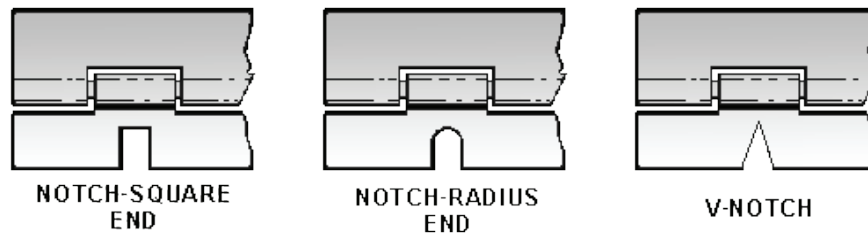
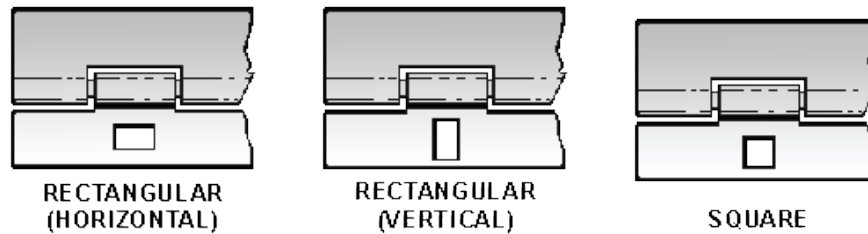
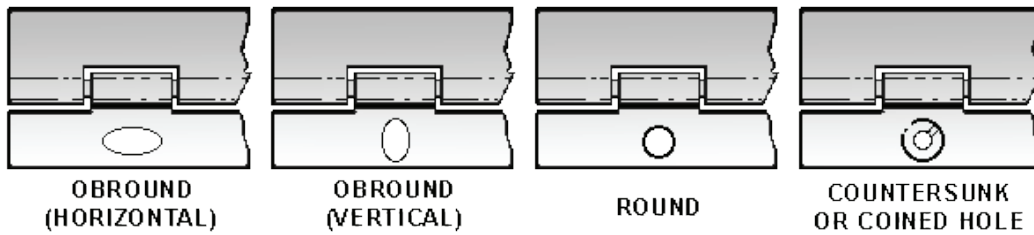
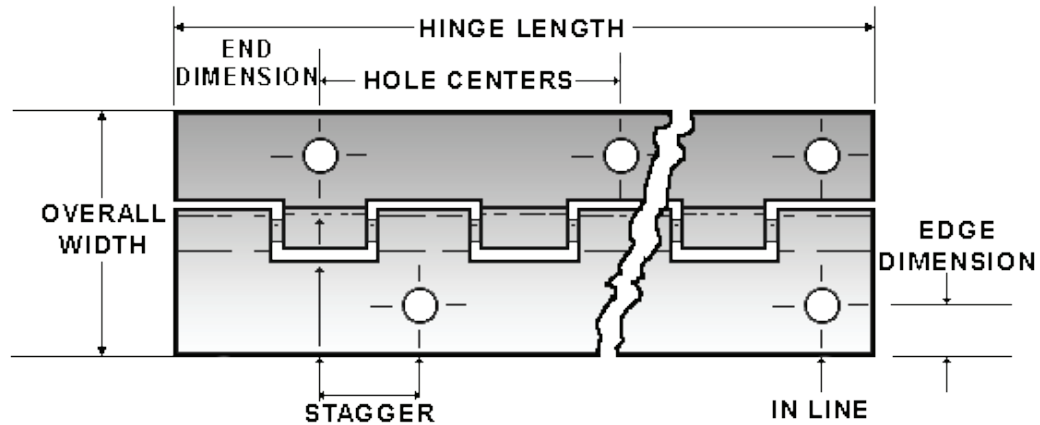



# HINGECRAFT

CORPORATION  
3601 LEXINGTON PARK DR. ELKHART, IN 46514



## Hinge Terminology

### Notched Leaves

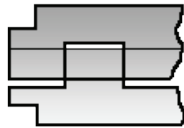

CORNERS NOTCHED

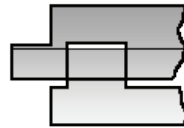

COMPLETE CORNER NOTCH

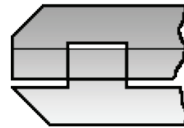

ANGLED CORNERS

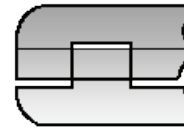

RADIUS CORNERS

### Butt Hinges



TIGHT PIN  
STACKED, FLUSH CUT

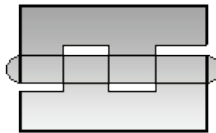

TIGHT PIN  
SPUN BOTH ENDS

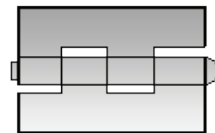

LOOSE PIN  
SPUN ONE HEAD ONLY

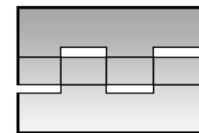

LOOSE PIN - NOT  
STACKED, FLUSH CUT

### Formed Leaves

Formed hinge leaves can be supplied in a variety of configurations. Dimensions should be taken from the pin center line and inside of forms. Several examples are shown below.



BOTH LEAVES FORMED  
DOWN 90°



ONE LEAF FORMED  
UP 90°



BOTH LEAVES FORMED  
UP 90°

### Multi-Pin Hinges

Multiple pin hinges allow for double action, as required.



### Unequal Leaves

Unequal leaves are available on all hinges. Widths are measured from the pin center line to the leaf's outer edge.

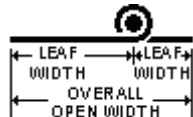



# HINGECRAFT

CORPORATION  
3601 LEXINGTON PARK DR. ELKHART, IN 46514



## Standard Hinges

Series	350	500	600	650	700	900	1200
Open Width↓ / Thickness→	.035	.050	.060	.060	.070	.090	.120
1-1/16"	3517	5017	6017				
1-1/4"	3520	5020	6020	6520			
1-1/2"	3524	5024	6024	6524	7524		
1-3/4"	3528	5028	6028	6528			
2"	3532	5032	6032	6532	7532	9032	
2-1/2"	3540	5040	6040	6540	7540	9040	
3"	3548	5048	6048	6548	7548	9048	12048
3-1/2"		5056	6056	6556	7556	9056	12056
4"		5064	6064	6564	7564	9064	12064
4-1/2"		5072	6072	6572	7572	9072	12072
5"		5080	6080	6580	7580	9080	12080
5-1/2"		5088	6088	6588		9088	12088
6"		5096	6096	6596		9096	12096
Pin Diameter	.085	.120	.120	0.187	3/16/.250	.250	3/8"
Knuckle Length	1/4"	1/2"	1/2"	1/2"	1/2"/1"	1"	2"
Plain Steel (PS)	.	.	.	.	.	.	.
Stainless Steel (SS)	.	.	.	.	.	.	.
Aluminum (A)	.	.	.			.	.
Nickel Plated Steel (NPS)	.						
Brass Plated Steel (BPS)	.						

**PS** = Plain Steel  
**SS** = Stainless Steel  
**A** = Aluminum

**NPS** = Nickel Plated Steel  
**BPS** = Brass Plated Steel

This chart lists our **standard continuous hinges**, which have equal leaves, a 270-degree travel, are assembled and have similar pin and leaf material. These hinges are available in **6 foot and 8 foot lengths** and provide you with the most economical hinge, with fastest shipment.

Whenever possible substitute our standard hinge for your current hinge, or design your new products to conform to our standard hinges. You will realize a considerable advantage in cost and delivery.



# HINGECRAFT

CORPORATION  
3601 LEXINGTON PARK DR. ELKHART, IN 46514



## A Continuous Hinge

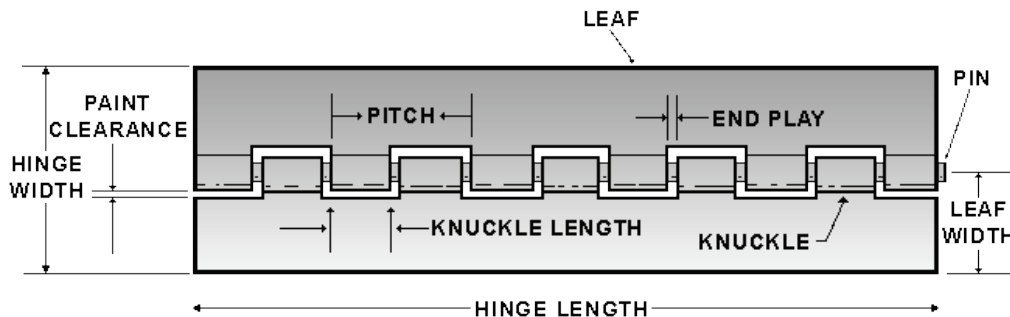

## Materials

### Hingecraft Materials + Decoder

A*	=	Aluminum	A*WHITE	=	Aluminum (White)
BPS*	=	Brass Plated Steel	CRS*	=	Cold Roll Steel
GALVAN.G-60*	=	Galvanized	GALVANNEAL*	=	Galvanneal
HRP&O*	=	Hot Roll Pickle & Oil	NPS*	=	Nickel Plated Steel
SS3042B*	=	Stainless Steel	SS304BRT*	=	Stainless Steel (Bright)

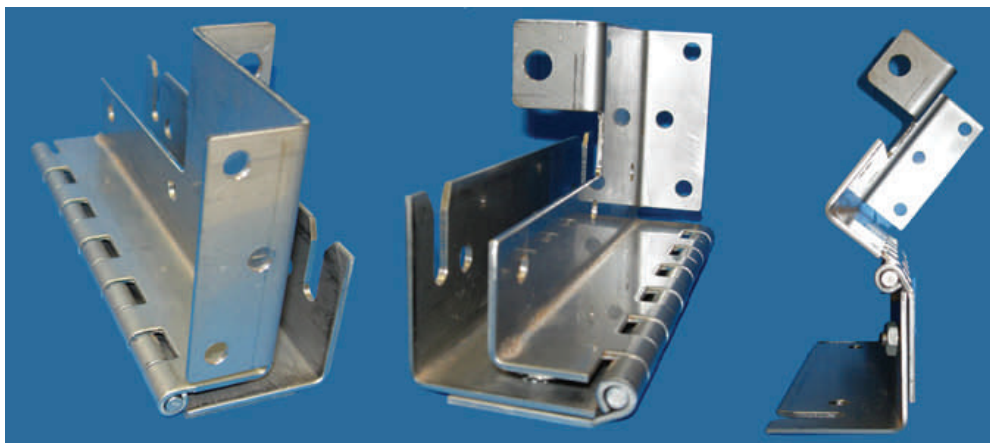



Thanks for taking the time to look over our brochure. Please do not hesitate to contact us to see how we can help you meet your hinge needs.

# HINGECRAFT

CORPORATION

3601 LEXINGTON PARK DRIVE, ELKHART, IN 46514

PHONE: (574) 293-6543

FAX: (574) 293-3199